



OPERABLE ALUMINUM LOUVER XC-690W-0 XCF-690W-0

STANDARD SPECIFICATIONS

- CONST. - 6063-T5 EXTRUDED ALUMINUM, BUTT CORNERS, MULLIONS & SPREADER BARS ON SECTIONS 72" (1828.8MM) AND HIGHER
- FRAME - 6" X 1" X 1.51", (152.4MM X 25.4MM 2.1MM) HEADER CHANNEL, BUTT CORNERS, WELDED
- BLADES - 4" X .081", (101.6MM X 2.1MM) EXTRUDED ALUMINUM, OPEN TO 90°, 5.8" (147.3MM) BLADE SPACING, EXTRA WEATHERLIP IN CENTER
- SEALS - DUAL DUROMETER VINYL BLADE TIP & 2 (50.8MM) STAINLESS STEEL SIDE SEALS
- SHAFTS - .5" (12.7MM) DIAMETER C.R.PLATED STEEL
- BEARINGS - .5" (12.7MM) NYLON BUSHINGS
- LINKAGE - IN AIRSTREAM ON INSIDE FACE, ROD TRAVEL 3.39" (86.1MM) AT 45° AND 5.34" (135.7MM) AT 90°
- FINISH - MILL ALUMINUM
- SIZE - MINIMUM 12" W X 18" H (304.8MM X 457.2MM)
MAXIMUM 48" W X 96" H (1219.2MM X 2438.4MM)

OPTIONS

- FRAME - XCF-ADD FLANGE FRAME 1.5" (38.1MM) USING A 2.5" X .081" (63.5MM X 2.1MM)
- BLADES - .125" (3.2MM) 8 GAUGE EXTR. ALUMINUM
- BEARINGS - OILITE BRONZE BUSHINGS, BALL BEARING
- SCREEN - IN FRAME, SCREWED ON OUTSIDE FACE
- FINISH - BAKED ENAMEL, ANODIZED, & OTHERS
- CONTROL - MAN. WING NUT, SPRING & CHAIN, JACK SHAFTS & BRACKETS, MOTORIZED

TECHNICAL NOTES

- RECOMMENDED FOR EXHAUST MODE ONLY
- CAUTION - NOT RECOMMENDED FOR INTAKE AT FULL OPEN POSITION
- SHIPPING WEIGHT - APPROX. 6 LBS./SQ. FT.

LOUVERS ARE MANUFACTURED .5" (12.7MM) SMALLER THAN ORDERED SIZE UNLESS EXACT DIMENSIONS ARE STATED.

* FOR MORE INFORMATION, CONTACT OUR FACTORY *

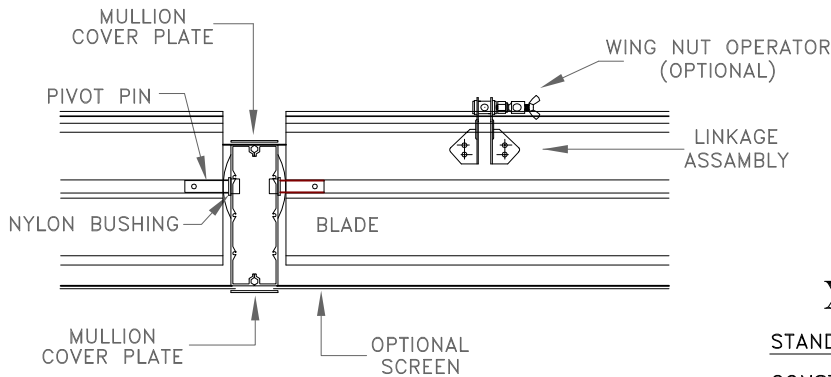

HORIZONTAL SECTION

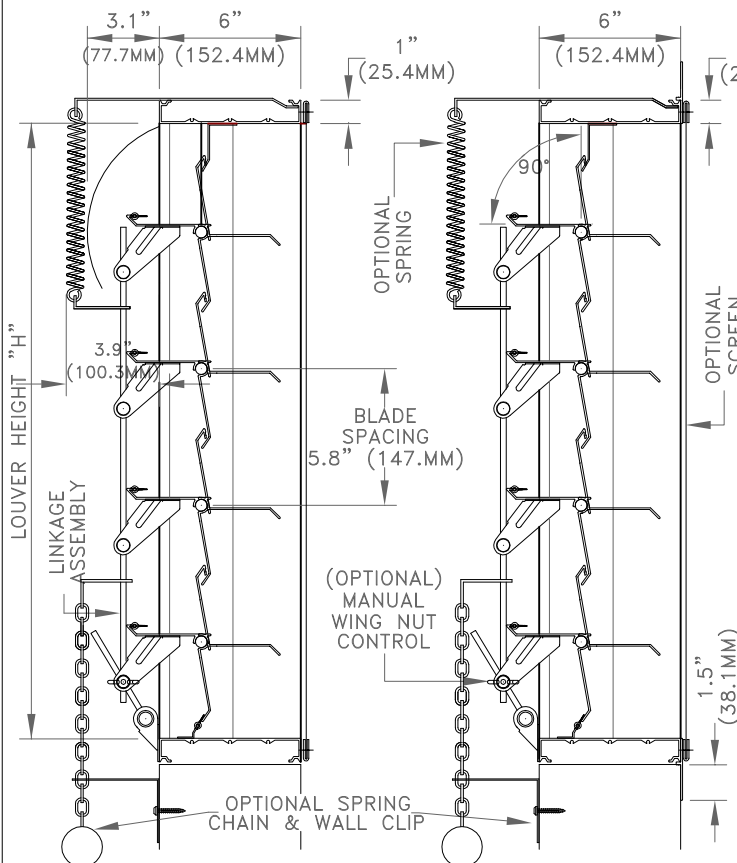

XC-690W-0
VERTICAL SECTION

XCF-690W-0
VERTICAL SECTION

NOTES

APPROVAL

DATE:
PROJECT:
ENGINEER:
CUSTOMER:
DISTRIBUTOR:

XC-690W-0