

HORIZONTAL SECTION



STEEL LOUVER SC-245 SF-245

STANDARD SPECIFICATIONS

- CONST. - FORMED GALVANIZED STEEL, WELDED ASSEMBLY
- FRAME - 2" X 1" X 20 GA. (50.8MM X 25.4MM X 1MM) CHANNEL, BUTT CORNERS
- BLADES - 2" X 20 GA. (50.8MM X 1MM) SET AT 45°, 2" (50.8MM) BLADE SPACING, SUPPORTS AT 24" (609.6MM) W CENTERS
- SCREEN - .5" X .5" X 18 GAUGE (12.7MM X 12.7MM) GALVANIZED, SCREW FASTENED
- FINISH - MILL GALVANIZED
- SIZE - MINIMUM 12" W X 12" H (304.8MM X 304.8MM)
 MAXIMUM SECTION WIDTH 60" (1524MM)
 MAXIMUM SECTION HEIGHT 72" (1828.8MM)
 MAXIMUM SECTION SIZE 30 SQ. FT.

OPTIONS

- CONST. - HEAVIER GAUGES
- FRAME - SF-FLANGE FRAME 1.5" X 20 GAUGE (38.1MM X 1MM) MITRED CORNERS
- SCREEN - AS PER REQUEST
- FINISH - MINIMUM PRIME COAT OR BAKED ENAMEL IS RECOMMENDED

TECHNICAL NOTES

- CORROSION RESISTANCE IS LOST UPON WELDING, SEE OPTIONAL FINISHES ABOVE
- MAX. REC. INTAKE VEL. - 735 FPM THROUGH FREE AREA
- SHIPPING WEIGHT - APPROX. 6 LBS./SQ. FT.
- LOUVERS ARE MANUFACTURED .5" (12.7MM) SMALLER THAN ORDERED SIZE UNLESS EXACT DIMENSIONS ARE STATED.

* FOR MORE INFORMATION, CONTACT OUR FACTORY *

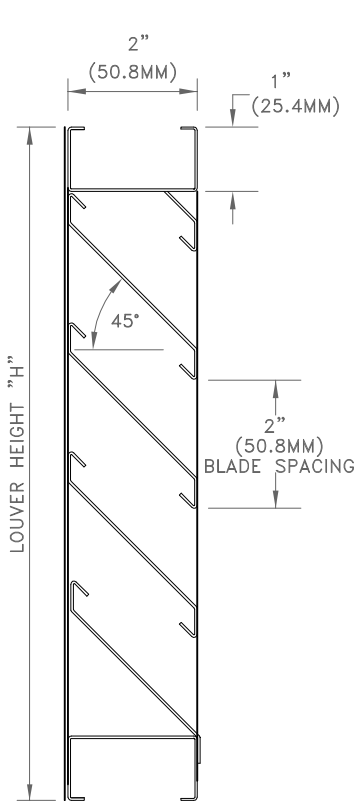

SC-245
VERTICAL SECTION

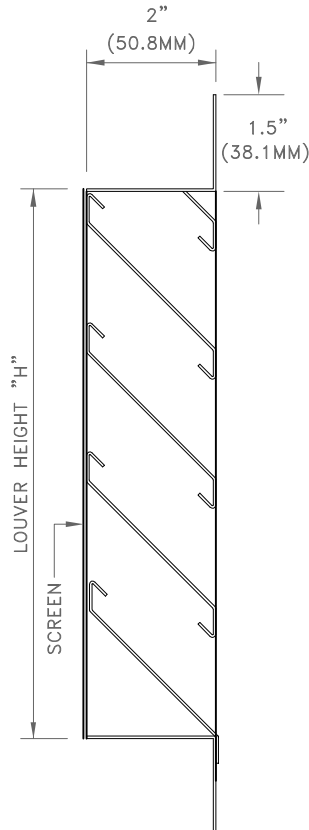

SF-245
VERTICAL SECTION

NOTES

APPROVAL

DATE:
PROJECT:
ENGINEER:
CUSTOMER:
DISTRIBUTOR:

SC-245



STEEL LOUVER SC-245

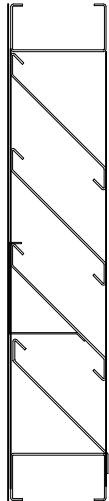

TEST
CONDITIONS:
A 48" X 48"
LOUVER WAS
USED FOR
THE TEST;
AT STANDARD
AIR DENSITY
AND
OPERATING
TEMPERATURE
RANGE OF
65°F - 85°F,
AND
15 MINUTES
TEST DURATION

		WIDTH (INCHES)										
		12	18	24	30	36	42	48	54	60	66	72
HEIGHT (INCHES)	8	0.26	0.42	0.57	0.73	0.89	1.04	1.28	1.35	1.51	1.67	1.82
	12	0.43	0.69	0.95	1.22	1.48	1.74	2.80	2.26	2.52	2.78	3.84
	16	0.61	0.97	1.34	1.78	2.07	2.43	2.88	3.16	3.52	3.89	4.25
	20	0.78	1.25	1.72	2.19	2.66	3.13	3.59	4.06	4.53	5.08	5.47
	24	0.95	1.53	2.10	2.67	3.25	3.82	4.39	4.97	5.54	6.11	6.68
	28	1.13	1.81	2.48	3.16	3.84	4.51	5.19	5.87	6.55	7.22	7.98
	32	1.30	2.08	2.86	3.65	4.43	5.21	5.99	6.77	7.55	8.33	9.11
	36	1.48	2.36	3.25	4.13	5.02	5.98	6.79	7.67	8.56	9.44	10.33
	48	1.65	2.64	3.63	4.62	5.61	6.60	7.59	8.58	9.57	10.56	11.53
	44	1.82	2.92	4.01	5.10	6.20	7.29	8.39	9.48	10.57	11.67	12.76
	48	2.00	3.19	4.39	5.59	6.79	7.99	9.18	10.38	11.58	12.78	13.98
	52	2.17	3.47	4.77	6.08	7.38	8.68	9.98	11.28	12.59	13.89	15.19
	56	2.34	3.75	5.16	6.56	7.97	9.38	10.78	12.19	13.59	15.00	16.41
60	2.52	4.03	5.53	7.05	8.56	10.07	11.58	13.09	14.68	16.11	17.62	
64	2.69	4.31	5.87	7.53	9.15	10.76	12.38	13.99	15.61	17.22	18.84	
68	2.86	4.58	6.25	8.02	9.74	11.46	13.18	14.90	16.61	18.33	20.05	
72	3.04	4.86	6.63	8.51	10.33	12.15	13.98	15.88	17.62	19.44	21.27	

FREE AREA TABLE (SQUARE FEET)
RATINGS INCLUDE THE EFFECT OF A BIRD SCREEN

WATER PENETRATION
OUNCES PER SQ.FT. FREE AREA
BASED IN 15 MIN. DURATION

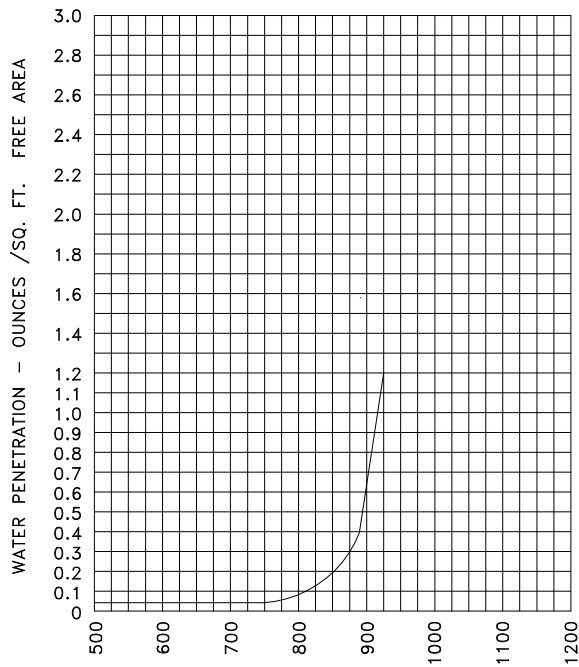

WATER PENETRATION GRAPH
735 F.P.M. BEGINNING OF WATER PENETRATION
(8.35 MPH WIND)

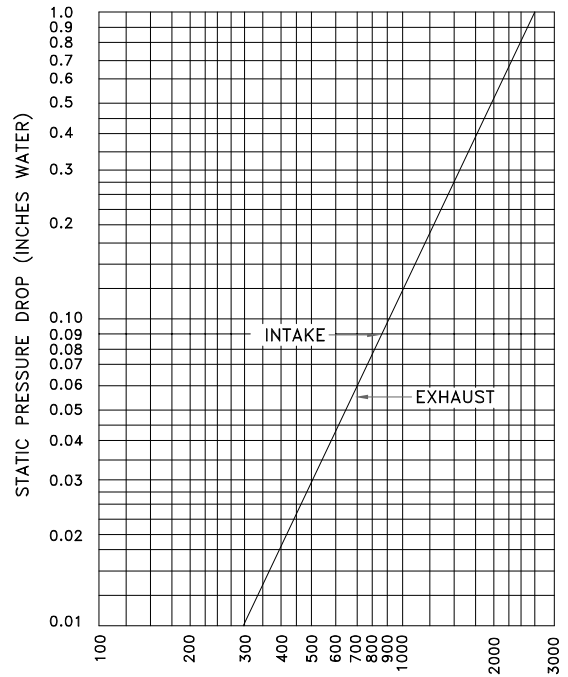

AIR PERFORMANCE GRAPH

THE INFORMATION CONTAINED ON THIS DATA SHEET REMAINS THE PROPERTY OF WESTERN VENTILATION PRODUCTS LTD. AND IS PROTECTED BY COPYRIGHT. WESTVENT AIR PERFORMANCE RATINGS SHOWN ARE BASED ON TESTS MADE BY TECHNICIANS IN OUR TEST LABORATORY.