

MULTI SPAN INTAKE HOOD MSI RELIEF HOOD MSR

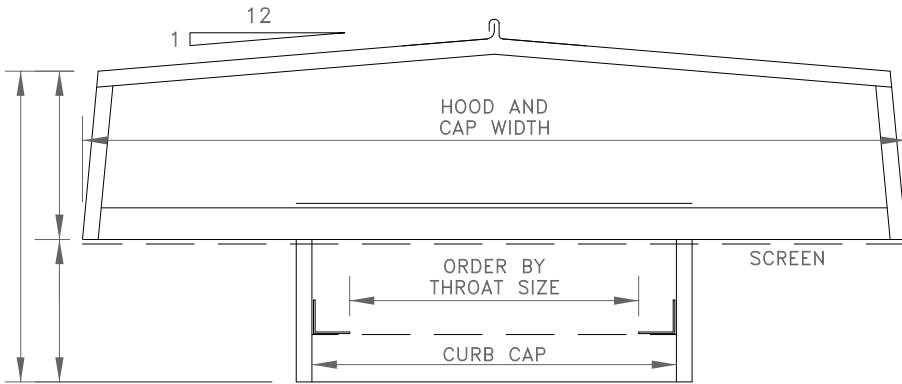

STANDARD SPECIFICATIONS

- CONST. - GALVANIZED STEEL BASE AND WEATHER HOOD. COMPLETELY ASSEMBLED
 FRAME - HOOD SUPPORTED BY PAINTED ANGLE IRON
 SCREEN - .5" X .5" X 18 GA. (12.7MM X 12.7MM X 1.3MM) GALVANIZED
 FINISH - MILL GALVANIZED STEEL
 SIZE - MIN: 12" W X 12" (304.8MM X 304.8MM)
 MAX: 48" W X 96" (1219.2MM X 2438.4MM)
 ORDER BY THROAT SIZE (FREE AREA)

OPTIONS

- CONST. - ALUMINUM AND HEAVIER GAUGES
 FRAME - HOOD SUPPORTED BY ALUMINUM ANGLE
 SCREEN - AS PER REQUEST
 INSUL. - AS PER REQUEST
 FINISH - MILL ALUMINUM, PRIME COAT, BAKED ENAMEL
 FILTERS - FILTER RACKS AND FILTERS.
 ACCESS - BACK DRAFT DAMPERS, CONTROL DAMPERS

TECHNICAL NOTES

MODELS: MSI IS 2:1 & MSR IS 1:1 FREE AREA RATIO

PLEASE SEND COPY OF SHOP DRAWINGS, WITH DIMENSION REQUIRED

NOTE: O.D. OF CURB SHOULD BE 1" (25.4MM) LESS THAN HOOD CURB CAP

* FOR MORE INFORMATION, CONTACT OUR FACTORY *

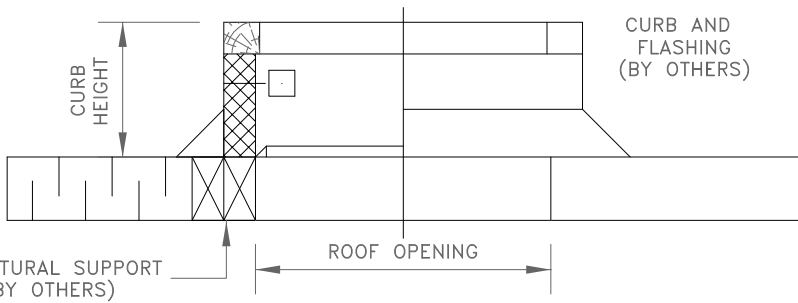

NOTE: OUTSIDE DIMENSION OF CURB SHOULD BE 1" (25.4MM) LESS THAN CURB CAP

PLEASE SEND COPY OF SHOP DRAWING WITH DIMENSIONS REQUIRED

MATERIAL THROAT SIZE	GALVANIZED STANDARD		ALUMINUM OPTIONAL	
	CURB CAP	HOOD	CURB CAP	HOOD
12" - 30" (304.8MM-762MM)	18 GA.	24 GA.	16 GA.	22 GA.
31" - 72" (787.4MM-1828.8MM)	16 GA.	20 GA.	14 GA.	18 GA.
73" X 144" (1854.2MM-3657.6MM)	12 GA.	18 GA.	10 GA.	16 GA.

NOTES

APPROVAL

QTY.	MODEL	THROAT SIZE	CURB CAP SIZE	HOOD SIZE
		X	X	X
		X	X	X

DATE:
 PROJECT:
 ENGINEER:
 CUSTOMER:
 DISTRIBUTOR: